

# Druckmessgerät mit Rohrfedersystem, Cr-Ni-Stahl

## Bourdon tube pressure gauge, stainless steel

### Manomètres à tube de Bourdon, acier inox

R20



- **Anwendung**  
Für gasförmige und flüssige, nicht hochviskose und nicht kristallisierende aggressive Messstoffe.
- **Service intended**  
Suitable for all gaseous and liquid media that will not obstruct the pressure system.
- **Utilisation**  
Pour fluides gazeux et liquides, non visqueux non cristallisants et non agressifs.

| Technische Daten   | Technical data  | Caractéristiques techniques  |
|--|---|--|
| <b>Ausführung</b><br>EN 837-1 - Code S1  | <b>Construction</b><br>EN 837-1 - Code S1   | <b>Version</b><br>EN 837-1 - Code S1   |
| <b>Gehäuse</b><br>Ø 60, 100, 160 und 250 mm Edelstahl<br>mit Ausblasvorrichtung  | <b>Case</b><br>Ø 60, 100, 160 and 250 mm stainless steel<br>with pressure relief  | <b>Boîtier</b><br>Ø 60, 100, 160 et 250 mm acier inox<br>avec évént de sécurité  |
| <b>Schutzart</b><br>IP 54 nach EN 60529 / IEC 529  | <b>Degree of protection</b><br>IP 54 per EN 60 529 / IEC 529  | <b>Degré de protection</b><br>IP 54 selon EN 60529 / IEC 529   |
| <b>Anschluss</b><br>Ø 60 mm : G1/4B, 1.4404<br>Ø 100, 160 und 250 mm : G1/2B, 1.4404   | <b>Pressure connection</b><br>Ø 60 mm : G1/4B, 316L<br>Ø 100, 160 and 250 mm : G1/2B, 316L  | <b>Raccord</b><br>Ø 60 mm : G1/4B, Z3 CND 17-11-02<br>Ø 100, 160 et 250 mm : G1/2B, Z3 CND 17-11-02  |
| <b>Messorgan</b><br>Edelstahl 1.4404   | <b>Pressure element</b><br>Stainless steel 316L   | <b>Organe moteur</b><br>Acier inox Z3 CND 17-11-02   |
| <b>Zeigerwerk</b><br>Edelstahl   | <b>Movement</b><br>Stainless steel  | <b>Mouvement</b><br>Acier inox   |
| <b>Zeiger</b><br>Aluminium, schwarz  | <b>Pointer</b><br>Aluminium, black  | <b>Aiguille</b><br>Duralumin, noir   |
| <b>Zifferblatt</b><br>Aluminium, weiß<br>Skala und Beschriftung schwarz  | <b>Dial</b><br>Aluminium, white<br>Scale and lettering black  | <b>Cadran</b><br>Duralumin, blanc<br>Échelle et graduation en noir   |
| <b>Sichtscheibe</b><br>Mehrschichten-Sicherheitsglas   | <b>Window</b><br>Laminated safety glass   | <b>Voyant</b><br>Verre de sécurité feuilleté   |
| <b>Genauigkeitsklasse</b><br>Ø 60 mm : 1,6<br>Ø 100, 160 und 250 mm : 1,0  | <b>Accuracy class</b><br>Ø 60 mm : 1,6<br>Ø 100, 160 and 250 mm : 1,0   | <b>Précision</b><br>Ø 60 mm : 1,6<br>Ø 100, 160 et 250 mm : 1,0  |
| <b>Temperatureinfluss, T<sub>Ref</sub> 20°C</b><br>Temperaturzunahme : +0,3% FS / 10K<br>Temperaturabnahme : - 0,3% FS / 10K                   | <b>Temperature error, T<sub>ref</sub> 20°C</b><br>Rising temperature : +0,3% FS / 10 K<br>Falling temperature : - 0,3% FS / 10 K          | <b>Influence de la température T<sub>ref</sub> 20°C</b><br>Hausse des températures: +0,3% de l'EM/10 K<br>Baisse des températures: -0,3% de l'EM/10 K      |
| <b>Umgebungstemperatur</b> T <sub>min</sub> / T <sub>max</sub><br>- 40°C ... + 60°C  | <b>Ambient temperature</b> T <sub>min</sub> / T <sub>max</sub><br>- 40°C ... + 60°C   | <b>Température ambiante</b> T <sub>mini</sub> / T <sub>maxi</sub><br>- 40°C ... + 60°C   |
| <b>Messstofftemperatur</b> T <sub>max</sub><br>+200°C  | <b>Medium temperature</b> T <sub>max</sub><br>+200°C  | <b>Température du fluide</b> T <sub>maxi</sub><br>+200°C   |
| <b>Belastung</b><br>ruhende Last : 1,0 x Skalenendwert<br>dynamische Last : 0,9 x Skalenendwert<br>kurzfristige Überlast : 1,3 x Skalenendwert | <b>Working pressure</b><br>Steady : 1,0 x full scale value<br>Fluctuating : 0,9 x full scale value<br>Short time : 1,3 x full scale value | <b>Plages d'utilisation</b><br>Charge statique : 100% de fin d'échelle<br>Charge dynamique : 90% de fin d'échelle<br>Momentanément : 130% de fin d'échelle |
| <b>Ergänzungen</b><br>siehe Tabellen Seiten 01.0405 - 01.0406  | <b>Optional extras</b><br>see tables pages 01.0405 - 01.0406  | <b>Options</b><br>voir tableaux pages 01.0405 - 01.0406  |
| <b>Grenzsignalgeber</b><br>siehe Seiten 01.1001 - 01.1002  | <b>Alarm contacts</b><br>see pages 01.1001 - 01.1002  | <b>Seuils d'alarme électriques</b><br>voir pages 01.1001 - 01.1002   |
| <b>Druckmittler</b><br>siehe Seiten 06.0000 - 06.1502  | <b>Chemical seals</b><br>see pages 06.0000 - 06.1502  | <b>Séparateurs à membrane</b><br>voir pages 06.0000 - 06.1502  |

# R20

## Druckmessgerät mit Rohrfedersystem, Cr-Ni-Stahl Bourdon tube pressure gauge, stainless steel Manomètres à tube de Bourdon, acier inox

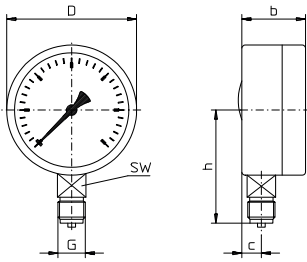

**Typ R20.U.1.N...**  
Anschluss unten  
bottom pressure entry  
raccord en bas

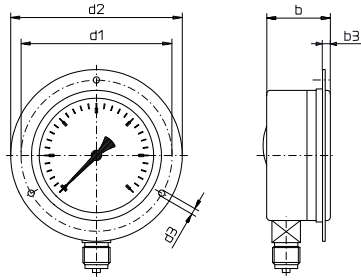

**Typ R20.U.2.N...**  
Rand vorne  
panel mounting flange  
collerette avant

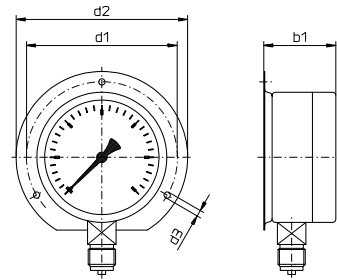

**Typ R20.U.3.N...**  
Rand hinten  
surface mounting flange  
rebord arrière

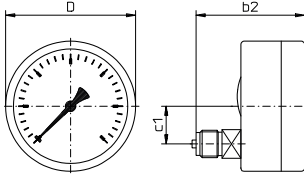

**Typ R20.H.1.N...**  
Anschluss hinten  
back pressure entry  
raccord arrière

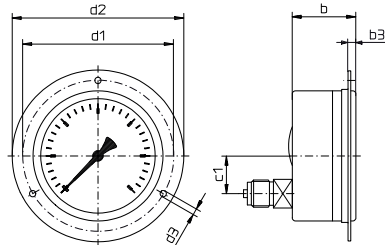

**Typ R20.H.2.N...**  
Rand vorne  
panel mounting flange  
collerette avant

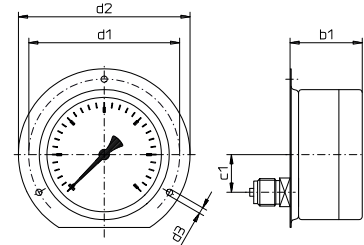

**Typ R20.H.3.N...**  
Rand hinten  
surface mounting flange  
rebord arrière

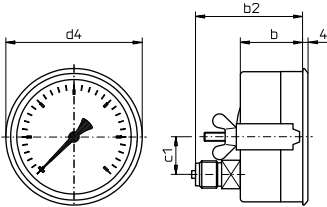

**Typ R20.H.4.N... \*)**  
Dreikantfronting  
triangular bezel  
collerette avant triangulaire

| NG  | b    | b1   | b2   | b3 | c  | c1  | mm  |     |     |     |     |     |                  | G                 | h  | SW               | Tafelausschnitt   |      | kg |
|-----|------|------|------|----|----|-----|-----|-----|-----|-----|-----|-----|------------------|-------------------|----|------------------|-------------------|------|----|
|     |      |      |      |    |    |     | D   | d1  | d2  | d3  | d4  | 65  | 63 <sup>1)</sup> |                   |    |                  |                   |      |    |
| 60  | 28,5 | 34,5 | 65   | 6  | 11 | 18  | 64  | 75  | 85  | 3,5 | 67  | G¼B | 46               | 14                | 65 | 63 <sup>1)</sup> | 0,12              |      |    |
| 100 | 50   | 56   | 86,5 |    | 15 | 29  | 100 | 116 | 132 | 4,8 | 107 |     | G½B              | 87                | 22 | 105              | 103 <sup>1)</sup> | 0,50 |    |
| 160 |      |      | 14,5 |    | 50 | 160 | 178 | 196 | 5,8 | 166 | 118 | 165 |                  | 163 <sup>1)</sup> |    | 1,10             |                   |      |    |
| 250 |      |      | 16   |    | 50 | 250 | 272 | 285 |     | -   | 165 | 254 |                  | -                 |    | 2,20             |                   |      |    |



Druckmessgeräte mit Rohrfedersystem und Grenzsignalgebern  
Bourdon tube pressure gauge with alarm contacts  
Manomètres à tube de Bourdon avec seuil d'alarme

01.1001  
-  
01.1002





Druckmittler  
Chemical seals  
Séparateurs

06.0101  
-  
06.1502

Stand: 24. 10. 2023

**Druckmessgerät mit Rohrfedersystem, Cr-Ni-Stahl**  
**Bourdon tube pressure gauge, stainless steel**  
**Manomètres à tube de Bourdon, acier inox**

**R20**

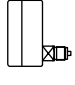
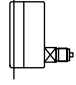
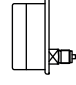
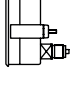
| Typ  | R20.U.1.N60   | R20.U.2.N60   | R20.U.3.N60   | R20.H.1.N60  | R20.H.2.N60   | R20.H.3.N60   | R20.H.4.N60   |
|--|---|---|---|--|---|---|---|
| <b>Ø 60mm</b>  |  |  |  |  |  |  |  |
| Anzeigebereich, bar<br>Scale range, bar<br>Etendues de mesure, bar | Bestell-Nr.<br>Order-N°.<br>N° de commande  |   |   |  |   |   |   |
| - 1 ... 0  | 101962  | 101990  | 102018  | 102046   | 102074  | 102102  | 102130  |
| - 0,6 ... 0 ... + 1,0  | 101963  | 101991  | 102019  | 102047   | 102075  | 102103  | 102131  |
| - 1 ... 0 ... + 0,6  | 101964  | 101992  | 102020  | 102048   | 102076  | 102104  | 102132  |
| - 1 ... 0 ... + 1,5  | 101965  | 101993  | 102021  | 102049   | 102077  | 102105  | 102133  |
| - 1 ... 0 ... + 3  | 101966  | 101994  | 102022  | 102050   | 102078  | 102106  | 102134  |
| - 1 ... 0 ... + 5  | 101967  | 101995  | 102023  | 102051   | 102079  | 102107  | 102135  |
| - 1 ... 0 ... + 9  | 101968  | 101996  | 102024  | 102052   | 102080  | 102108  | 102136  |
| - 1 ... 0 ... + 15   | 101969  | 101997  | 102025  | 102053   | 102081  | 102109  | 102137  |
| - 1 ... 0 ... + 24   | 101961  | 101989  | 102017  | 102045   | 102073  | 102101  | 102129  |
| 0,2 ... 1,0  | 101970  | 101998  | 102026  | 102054   | 102082  | 102110  | 102138  |
| 0 ... 0,6  | 101971  | 101999  | 102027  | 102055   | 102083  | 102111  | 102139  |
| 0 ... 1,0  | 101972  | 102000  | 102028  | 102056   | 102084  | 102112  | 102140  |
| 0 ... 1,6  | 101973  | 102001  | 102029  | 102057   | 102085  | 102113  | 102141  |
| 0 ... 2,5  | 101974  | 102002  | 102030  | 102058   | 102086  | 102114  | 102142  |
| 0 ... 4  | 101975  | 102003  | 102031  | 102059   | 102087  | 102115  | 102143  |
| 0 ... 6  | 101976  | 102004  | 102032  | 102060   | 102088  | 102116  | 102144  |
| 0 ... 10   | 101977  | 102005  | 102033  | 102061   | 102089  | 102117  | 102145  |
| 0 ... 16   | 101978  | 102006  | 102034  | 102062   | 102090  | 102118  | 102146  |
| 0 ... 25   | 101979  | 102007  | 102035  | 102063   | 102091  | 102119  | 102147  |
| 0 ... 40   | 101980  | 102008  | 102036  | 102064   | 102092  | 102120  | 102148  |
| 0 ... 60   | 101981  | 102009  | 102037  | 102065   | 102093  | 102121  | 102149  |
| 0 ... 100  | 101982  | 102010  | 102038  | 102066   | 102094  | 102122  | 102150  |
| 0 ... 160  | 101983  | 102011  | 102039  | 102067   | 102095  | 102123  | 102151  |
| 0 ... 250  | 101984  | 102012  | 102040  | 102068   | 102096  | 102124  | 102152  |
| 0 ... 400  | 101985  | 102013  | 102041  | 102069   | 102097  | 102125  | 102153  |
| 0 ... 600  | 101986  | 102014  | 102042  | 102070   | 102098  | 102126  | 102154  |
| 0 ...  | 101987  | 102015  | 102043  | 102071   | 102099  | 102127  | 102155  |

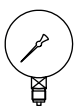
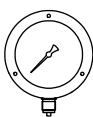
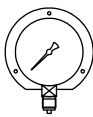
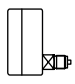
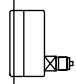
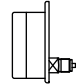
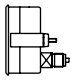
| Typ  | R20.U.1.N100  | R20.U.2.N100  | R20.U.3.N100  | R20.H.1.N100   | R20.H.2.N100  | R20.H.3.N100  | R20.H.4.N100  |
|--|---|---|---|--|---|---|---|
| <b>Ø 100mm</b>   |  |  |  |  |  |  |  |
| Anzeigebereich, bar<br>Scale range, bar<br>Etendues de mesure, bar | Bestell-Nr.<br>Order-N°.<br>N° de commande  |   |   |  |   |   |   |
| - 1 ... 0  | 102158  | 102186  | 102214  | 102242   | 102270  | 102298  | 102326  |
| - 0,6 ... 0 ... + 1,0  | 102159  | 102187  | 102215  | 102243   | 102271  | 102299  | 102327  |
| - 1 ... 0 ... + 0,6  | 102160  | 102188  | 102216  | 102244   | 102272  | 102300  | 102328  |
| - 1 ... 0 ... + 1,5  | 102161  | 102189  | 102217  | 102245   | 102273  | 102301  | 102329  |
| - 1 ... 0 ... + 3  | 102162  | 102190  | 102218  | 102246   | 102274  | 102302  | 102330  |
| - 1 ... 0 ... + 5  | 102163  | 102191  | 102219  | 102247   | 102275  | 102303  | 102331  |
| - 1 ... 0 ... + 9  | 102164  | 102192  | 102220  | 102248   | 102276  | 102304  | 102332  |
| - 1 ... 0 ... + 15   | 102165  | 102193  | 102221  | 102249   | 102277  | 102305  | 102333  |
| - 1 ... 0 ... + 24   | 102157  | 102185  | 102213  | 102241   | 102269  | 102297  | 102325  |
| 0,2 ... 1,0  | 102166  | 102194  | 102222  | 102250   | 102278  | 102306  | 102334  |
| 0 ... 0,6  | 102167  | 102195  | 102223  | 102251   | 102279  | 102307  | 102335  |
| 0 ... 1,0  | 102168  | 102196  | 102224  | 102252   | 102280  | 102308  | 102336  |
| 0 ... 1,6  | 102169  | 102197  | 102225  | 102253   | 102281  | 102309  | 102337  |
| 0 ... 2,5  | 102170  | 102198  | 102226  | 102254   | 102282  | 102310  | 102338  |
| 0 ... 4  | 102171  | 102199  | 102227  | 102255   | 102283  | 102311  | 102339  |
| 0 ... 6  | 102172  | 102200  | 102228  | 102256   | 102284  | 102312  | 102340  |
| 0 ... 10   | 102173  | 102201  | 102229  | 102257   | 102285  | 102313  | 102341  |
| 0 ... 16   | 102174  | 102202  | 102230  | 102258   | 102286  | 102314  | 102342  |
| 0 ... 25   | 102175  | 102203  | 102231  | 102259   | 102287  | 102315  | 102343  |
| 0 ... 40   | 102176  | 102204  | 102232  | 102260   | 102288  | 102316  | 102344  |
| 0 ... 60   | 102177  | 102205  | 102233  | 102261   | 102289  | 102317  | 102345  |
| 0 ... 100  | 102178  | 102206  | 102234  | 102262   | 102290  | 102318  | 102346  |
| 0 ... 160  | 102179  | 102207  | 102235  | 102263   | 102291  | 102319  | 102347  |
| 0 ... 250  | 102180  | 102208  | 102236  | 102264   | 102292  | 102320  | 102348  |
| 0 ... 400  | 102181  | 102209  | 102237  | 102265   | 102293  | 102321  | 102349  |
| 0 ... 600  | 102182  | 102210  | 102238  | 102266   | 102294  | 102322  | 102350  |
| 0 ... 1000   | 102183  | 102211  | 102239  | 102267   | 102295  | 102323  | 102351  |
| 0 ... 1600   | 102184  | 102212  | 102240  | 102268   | 102296  | 102324  | 102352  |
| 0 ... 2500   | 410120  | 410121  | 410122  | 410123   | 410124  | 410125  | 410126  |

Standt: 24. 10. 2023

**R20**

# Druckmessgerät mit Rohrfedersystem, Cr-Ni-Stahl

## Bourdon tube pressure gauge, stainless steel

### Manomètres à tube de Bourdon, acier inox

| Typ  | R20.U.1.N160                              | R20.U.2.N160 | R20.U.3.N160 | R20.H.1.N160 | R20.H.2.N160 | R20.H.3.N160 | R20.H.4.N160 |
|--|---|--------------|--------------|--------------|--------------|--------------|--------------|
| <b>Ø 160mm</b>   |   |              |              |              |              |              |              |
| Anzeigebereich, bar<br>Scale range, bar<br>Etendues de mesure, bar | Bestell-Nr.<br>Order-N°<br>N° de commande |              |              |              |              |              |              |
| - 1 ... 0  | 102354                                    | 102382       | 102410       | 102438       | 102466       | 102494       | 102522       |
| - 0,6 ... 0 ... + 1,0  | 102355                                    | 102383       | 102411       | 102439       | 102467       | 102495       | 102523       |
| - 1 ... 0 ... + 0,6  | 102356                                    | 102384       | 102412       | 102440       | 102468       | 102496       | 102524       |
| - 1 ... 0 ... + 1,5  | 102357                                    | 102385       | 102413       | 102441       | 102469       | 102497       | 102525       |
| - 1 ... 0 ... + 3  | 102358                                    | 102386       | 102414       | 102442       | 102470       | 102498       | 102526       |
| - 1 ... 0 ... + 5  | 102359                                    | 102387       | 102415       | 102443       | 102471       | 102499       | 102527       |
| - 1 ... 0 ... + 9  | 102360                                    | 102388       | 102416       | 102444       | 102472       | 102500       | 102528       |
| - 1 ... 0 ... + 15   | 102361                                    | 102389       | 102417       | 102445       | 102473       | 102501       | 102529       |
| - 1 ... 0 ... + 24   | 102353                                    | 102381       | 102409       | 102437       | 102465       | 102493       | 102521       |
| 0,2 ... 1,0  | 102362                                    | 102390       | 102418       | 102446       | 102474       | 102502       | 102530       |
| 0 ... 0,6  | 102363                                    | 102391       | 102419       | 102447       | 102475       | 102503       | 102531       |
| 0 ... 1,0  | 102364                                    | 102392       | 102420       | 102448       | 102476       | 102504       | 102532       |
| 0 ... 1,6  | 102365                                    | 102393       | 102421       | 102449       | 102477       | 102505       | 102533       |
| 0 ... 2,5  | 102366                                    | 102394       | 102422       | 102450       | 102478       | 102506       | 102534       |
| 0 ... 4  | 102367                                    | 102395       | 102423       | 102451       | 102479       | 102507       | 102535       |
| 0 ... 6  | 102368                                    | 102396       | 102424       | 102452       | 102480       | 102508       | 102536       |
| 0 ... 10   | 102369                                    | 102397       | 102425       | 102453       | 102481       | 102509       | 102537       |
| 0 ... 16   | 102370                                    | 102398       | 102426       | 102454       | 102482       | 102510       | 102538       |
| 0 ... 25   | 102371                                    | 102399       | 102427       | 102455       | 102483       | 102511       | 102539       |
| 0 ... 40   | 102372                                    | 102400       | 102428       | 102456       | 102484       | 102512       | 102540       |
| 0 ... 60   | 102373                                    | 102401       | 102429       | 102457       | 102485       | 102513       | 102541       |
| 0 ... 100  | 102374                                    | 102402       | 102430       | 102458       | 102486       | 102514       | 102542       |
| 0 ... 160  | 102375                                    | 102403       | 102431       | 102459       | 102487       | 102515       | 102543       |
| 0 ... 250  | 102376                                    | 102404       | 102432       | 102460       | 102488       | 102516       | 102544       |
| 0 ... 400  | 102377                                    | 102405       | 102433       | 102461       | 102489       | 102517       | 102545       |
| 0 ... 600  | 102378                                    | 102406       | 102434       | 102462       | 102490       | 102518       | 102546       |
| 0 ... 1000   | 102379                                    | 102407       | 102435       | 102463       | 102491       | 102519       | 102547       |
| 0 ... 1600   | 102380                                    | 102408       | 102436       | 102464       | 102492       | 102520       | 102548       |
| 0 ... 2500   | 412715                                    | 412716       | 412717       | 412718       | 412719       | 412720       | 412721       |
| Typ  | R20.U.1.N250                              | R20.U.2.N250 | R20.U.3.N250 | R20.H.1.N250 | R20.H.2.N250 | R20.H.3.N250 |              |
| <b>Ø 250mm</b>   |   |              |              |              |              |              |              |
| Anzeigebereich, bar<br>Scale range, bar<br>Etendues de mesure, bar | Bestell-Nr.<br>Order-N°<br>N° de commande |              |              |              |              |              |              |
| - 1 ... 0  | 102550                                    | 102578       | 102606       | 102634       | 102662       | 102690       |              |
| - 0,6 ... 0 ... + 1,0  | 102551                                    | 102579       | 102607       | 102635       | 102663       | 102691       |              |
| - 1 ... 0 ... + 0,6  | 102552                                    | 102580       | 102608       | 102636       | 102664       | 102692       |              |
| - 1 ... 0 ... + 1,5  | 102553                                    | 102581       | 102609       | 102637       | 102665       | 102693       |              |
| - 1 ... 0 ... + 3  | 102554                                    | 102582       | 102610       | 102638       | 102666       | 102694       |              |
| - 1 ... 0 ... + 5  | 102555                                    | 102583       | 102611       | 102639       | 102667       | 102695       |              |
| - 1 ... 0 ... + 9  | 102556                                    | 102584       | 102612       | 102640       | 102668       | 102696       |              |
| - 1 ... 0 ... + 15   | 102557                                    | 102585       | 102613       | 102641       | 102669       | 102697       |              |
| - 1 ... 0 ... + 24   | 102549                                    | 102577       | 102605       | 102633       | 102661       | 102689       |              |
| 0,2 ... 1,0  | 102558                                    | 102586       | 102614       | 102642       | 102670       | 102698       |              |
| 0 ... 0,6  | 102559                                    | 102587       | 102615       | 102643       | 102671       | 102699       |              |
| 0 ... 1,0  | 102560                                    | 102588       | 102616       | 102644       | 102672       | 102700       |              |
| 0 ... 1,6  | 102561                                    | 102589       | 102617       | 102645       | 102673       | 102701       |              |
| 0 ... 2,5  | 102562                                    | 102590       | 102618       | 102646       | 102674       | 102702       |              |
| 0 ... 4  | 102563                                    | 102591       | 102619       | 102647       | 102675       | 102703       |              |
| 0 ... 6  | 102564                                    | 102592       | 102620       | 102648       | 102676       | 102704       |              |
| 0 ... 10   | 102565                                    | 102593       | 102621       | 102649       | 102677       | 102705       |              |
| 0 ... 16   | 102566                                    | 102594       | 102622       | 102650       | 102678       | 102706       |              |
| 0 ... 25   | 102567                                    | 102595       | 102623       | 102651       | 102679       | 102707       |              |
| 0 ... 40   | 102568                                    | 102596       | 102624       | 102652       | 102680       | 102708       |              |
| 0 ... 60   | 102569                                    | 102597       | 102625       | 102653       | 102681       | 102709       |              |
| 0 ... 100  | 102570                                    | 102598       | 102626       | 102654       | 102682       | 102710       |              |
| 0 ... 160  | 102571                                    | 102599       | 102627       | 102655       | 102683       | 102711       |              |
| 0 ... 250  | 102572                                    | 102600       | 102628       | 102656       | 102684       | 102712       |              |
| 0 ... 400  | 102573                                    | 102601       | 102629       | 102657       | 102685       | 102713       |              |
| 0 ... 600  | 102574                                    | 102602       | 102630       | 102658       | 102686       | 102714       |              |
| 0 ... 1000   | 102575                                    | 102603       | 102631       | 102659       | 102687       | 102715       |              |
| 0 ... 1600   | 102576                                    | 102604       | 102632       | 102660       | 102688       | 102716       |              |
| 0 ... 2500   | 412771                                    | 412772       | 412773       | 412774       | 412775       | 412778       |              |

| Ergänzungsartikel<br>Optional extras<br>Options   | Ø 60                                       | Ø 100  | Ø 160  | Ø 250  |
|---|--|--------|--------|--------|
|   | Bestell-Nr.<br>Order-N°.<br>N° de commande |        |        |        |
| Frontring poliert<br>Bezel polished<br>Lunette polie  | 395448                                     | 395112 | 395113 | 395114 |
| Gehäuse tropensicher IP 64 EN 60529 / IEC 529<br>Case tropics-safe IP 64 EN 60529 / IEC 529<br>Boîtier résistant aux tropiques IP 64 EN 60529 / IEC 529               | 395559                                     | 395559 | 395559 | 395559 |
| Zeigerwerk achsgedämpft<br>Movement with axle damping<br>Axe du mouvement freiné  | -  | 395563 | 395564 | 395564 |
| Skala mit Feinteilung und Schneidenseiger<br>Scale with fine spacing and knife edge pointer<br>Échelle graduation fine et aiguille chantournée                        | 395595                                     | 395019 | 395044 | 395057 |
| Doppelskala, z.B. bar/psi<br>Dual scale, for example bar/psi<br>Échelle double, par exemple bar/psi   | 395071                                     | 395020 | 395045 | 395058 |
| Mehrfachskala<br>Multi scale<br>Échelle multiple  | 395671                                     | 395671 | 395671 | 395671 |
| Skalenaufschrift<br>Lettering<br>Inscriptions   | 395740                                     | 395740 | 395740 | 395740 |
| Kältemittelskala Druck / R717 ( NH <sub>3</sub> )<br>Refrigerant scale pressure/ R717 ( NH <sub>3</sub> )<br>Échelles frigorigènes pression/ R717 ( NH <sub>3</sub> ) | 395596                                     | 395585 | 395586 | 395587 |
| Klischee-Erstellung für Sonderskala<br>Block making for special scale<br>Confection de clichés pour échelles spéciales  | 395022                                     | 395023 | 395047 | 395060 |
| Mehrpreis je weitere Farbe auf dem Zifferblatt<br>Extra charge per additional colour on dial<br>Supplément de prix par couleur en plus sur le cadran                  | 395025                                     | 395025 | 395025 | 395025 |
| Messsystem aus Monel<br>Monel pressure element<br>Organe moteur en Monel  | 396629                                     | 395008 | 395041 | 395796 |
| Messsystem gereinigt für Sauerstoff<br>Degreased pressure element for oxygen<br>Organe moteur dégraissé pour oxygène  | 395069                                     | 395009 | 395042 | 395042 |
| Messsystem silikonfrei<br>Silicon free pressure element<br>Organe moteur exempt de silicone   | 395698                                     | 395698 | 395699 | 395699 |
| Messsystem überdrucksicher, mehr 1,3-fach<br>Pressure element overpressure safe > 1,3 time<br>Organe moteur résistant à plus de 1,3 fois de P                         | 395594                                     | 395010 | 395043 | 395043 |
| Drosselschraube im Anschlusszapfen 0,8mm Ø<br>Restrictor screw in connector 0,8 mm dia.<br>Vis frein de 0,8 mm dans le raccord  | 395108                                     | 395107 | 395107 | 395107 |
| Drosselschraube im Anschlusszapfen 0,3mm Ø<br>Restrictor screw in connector 0,3 mm dia.<br>Vis frein de 0,3 mm dans le raccord  | 396094                                     | 395588 | 395588 | 395588 |
| Anschlusszapfen G 1/4 B<br>Connector G 1/4 B<br>Raccord G 1/4 B   | -  | 395097 | 395097 | -      |
| Anschlusszapfen G 1/4 innen<br>Connector G 1/4 female<br>Raccord G 1/4 intérieur  | -  | 395768 | 395768 | 395768 |
| Anschlusszapfen G 3/8 B<br>Connector G 3/8 B<br>Raccord G 3/8 B   | -  | 395101 | 395101 | 395101 |
| Anschlusszapfen M 20 x 1,5<br>Connector M 20 x 1,5<br>Raccord M 20 x 1,5  | -  | 395102 | 395102 | 395102 |
| Anschlusszapfen 1/4-NPT<br>Connector 1/4-NPT<br>Raccord 1/4-NPT   | 395103                                     | 395103 | 395103 | -      |
| Anschlusszapfen 3/8-NPT<br>Connector 3/8-NPT<br>Raccord 3/8-NPT   | -  | 395104 | 395104 | 395104 |

Stand: 24. 10. 2023

| Ergänzungsartikel<br>Optional extras<br>Options  | Ø 60                                      | Ø 100  | Ø 160  | Ø 250  |
|--|---|--------|--------|--------|
|  | Bestell-Nr.<br>Order-N°<br>N° de commande |        |        |        |
| Anschlusszapfen 1/2-NPT<br>Connector 1/2-NPT<br>Raccord 1/2-NPT  | -   | 395105 | 395105 | 395105 |
| Anschlusszapfen M16 x 1,5 innen / Novaswiss/Autoclave<br>Connector M16 x 1,5 female / Novaswiss/Autoclave<br>Raccord M16 x 1,5 intérieur / Novaswiss/Autoclave   | -   | 395007 | 395007 | 395007 |
| Anschlusszapfen 9/16-18 UNF innen / Novaswiss/Autoclave<br>Connector 9/16-18 UNF female / Novaswiss/Autoclave<br>Raccord 9/16-18 UNF intérieur / Novaswiss/Autoclave   | -   | 395035 | 395035 | 395035 |
| Anschlusszapfen 7/16 UNF innen / Maximator ( mittlerer Druck )<br>Connector 7/16 UNF female / Maximator ( medium pressure )<br>Raccord 7/16 UNF intérieur / Maximator ( pression moyenne )                   | -   | 390825 | 390825 | 390825 |
| Anschlusszapfen 9/16-18 UNF innen / Maximator ( mittlerer Druck )<br>Connector 9/16-18 UNF female / Maximator ( medium pressure )<br>Raccord 9/16-18 UNF intérieur / Maximator ( pression moyenne )          | -   | 396588 | 396588 | 396588 |
| Anschlusszapfen 3/4-16 UNF innen / Maximator ( Hochdruck )<br>Connector 3/4-16 UNF female / Maximator ( high pressure )<br>Raccord 3/4-16 UNF intérieur / Maximator ( haute pression )                       | -   | 396090 | 396090 | 396090 |
| Anschlusszapfen 9/16-18 UNF innen / Maximator ( Hochdruck )<br>Connector 9/16-18 UNF female / Maximator ( high pressure )<br>Raccord 9/16-18 UNF intérieur / Maximator ( haute pression )                    | -   | 390848 | 390848 | 390848 |
| Anschlusszapfen 7/16-20 UNF Hydraulik-SAE J514, mit Dichtkonus 74°<br>Connector 7/16-20 UNF Hydraulik-SAE J514, with sealing cone 74°<br>Raccord 7/16-20 UNF Hydraulik-SAE J514, avec cône d'étanchéité 74°  | 396607                                    | 396607 | 396607 | 396607 |
| Anschlusszapfen 7/16-20 UNF Hydraulik-SAE J513, mit Dichtkonus 90°<br>Connector 7/16-20 UNF Hydraulik-SAE J513, with sealing cone 90°<br>Raccord 7/16-20 UNF Hydraulik-SAE J513, avec cône d'étanchéités 90° | 395106                                    | 395106 | 395106 | 395106 |
| Anschlusszapfen G1/2 B, DIN 16288 Form D für Dichtlinse<br>Connector G1/2 B, DIN 16288 Form D für for sealing lens<br>Raccord G1/2 B, DIN 16288 Form D für pour lentille d'étanchéité                        | 396362                                    | 396362 | 396362 | 396362 |
| Anschlusszapfen 5/8-18 UNF-2B<br>Connector 5/8-18 UNF-2B<br>Raccord 5/8-18 UNF-2B  | 396361                                    | 396361 | 396361 | 396361 |
| drehbarer Anschlusszapfen<br>Rotary connector<br>Raccordement tournant   | -   | 395654 | -      | -      |
| Kleinflansch DIN28403 ISO2861DN 10, Edelstahl<br>Miniature flange DIN28403 ISO2861DN 10, stainless steel<br>Bride miniature DIN28403 ISO2861DN 10, acier inox  | -   | 395592 | 395592 | 395592 |
| rote Marke auf dem Zifferblatt<br>Red mark on dial<br>Trait rouge sur le cadran  | 395074                                    | 395026 | 395026 | 395026 |
| roter Markenzeiger in der Scheibe<br>Red mark pointer in window<br>Aiguille rouge sur le voyant  | 395075                                    | 395027 | 395048 | 395061 |
| roter Markenzeiger auf dem Zifferblatt<br>Red mark pointer on dial<br>Aiguille rouge sur le cadran   | 395076                                    | 395028 | 395049 | 395062 |
| 1-fach Schleppezeiger, rückstellbar<br>One-way reset maximum pointer<br>Aiguille suiveuse simple avec remise à zéro  | 395077                                    | 395029 | 395050 | 395063 |
| 2-fach Schleppezeiger, rückstellbar<br>Two-way reset maximum pointer<br>Aiguille suiveuse double avec remise à zéro  | 396097                                    | 395030 | 395051 | 395064 |
| Zeiger mit Zahntriebverstellung<br>Adjustable pointer on bushing<br>Aiguille micrométrique   | 396095                                    | 395031 | 395052 | 396096 |
| DAkKS - kalibrierfähig<br>DAkKS - calibrateable<br>DAkKS - étalonnable   | 395032                                    | 395032 | 395032 | 395032 |
| Schweißpunktsicherung für Bajonettring<br>Spotweld protection for bayonet ring<br>Assurance de la baïonnette par point de soudure  | 395763                                    | 395763 | 395763 | 395763 |
| Drucksensor in der Gehäuserückseite eingebaut<br>Pressure sensor integrated in the back case<br>Sensor de pression monté en la boîte derrière  | 410683                                    | 410683 | 410683 | 410683 |
| Zündschutzart<br>Intrinsic safety<br>Sécurité intrinsèque  | 104101                                    | 104101 | 104101 | 104101 |
|  II 2G Ex h IIC T6...T1 Gb X<br>II 2D Ex h IIC T6...T1 Db X   |   |        |        |        |

Stand: 24. 10. 2023