

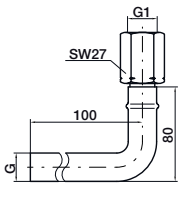
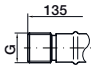
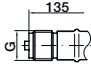

Anschlussrohre Joining pipes Tubes de raccordement

Technische Daten	Technical Data	Caractéristiques techniques
Material Stahl St 1.0305, wahlweise Edelstahl 1.4571	Materials Steel A226, alternatively stainless steel 316Ti	Matière Acier C 10 D, facultativement acier inox Z6 CNDT 17-12
Zulässige Temperaturen T_{max} °C 120 °C bei 100 bar 300 °C bei 80 bar 400 °C bei 60 bar	Permissible temperatures T_{max} °C 120 °C at 100 bar 300 °C at 80 bar 400 °C at 60 bar	Températures autorisées T_{max} °C 120 °C de 100 bar 300 °C de 80 bar 400 °C de 60 bar

Anschlussrohr, Winkel Form Joining pipe, angle design Tube de raccordement, forme angulaire				
	Bestell-Nr. Order N° N° de commande		Gewinde thread pas de vis	
	1.0305 A 226 C 10 D	1.4571 316Ti Z6CNDT17-12	G1	G
	395413	395414	G1/2"	Ø20
	395415	395416	M20x1,5	
	Anschlusszapfen, DIN 16282 Form 6 Connection, DIN 16282 Form 6 Raccordement, DIN 16282 Form 6			
	396643	396645	G1/2"	G1/2"B-RH
	396644	396646	M20x1,5	G1/2"B-LH
	Anschlusszapfen, DIN 16282 Form 4 Connection, DIN 16282 Form 4 Raccordement, DIN 16282 Form 4			
	396647	396649	G1/2"	G1/2"B-RH
	396648	396650	M20x1,5	G1/2"B-LH
	Anschlusszapfen, mit Sechskant Connection with hex head Raccordement, avec tête hexagonale			
	396651	396653	G1/2"	G1/2B
	396652	396654	M20x1,5	

Anschlussrohr, gerade Form Joining pipe, straight design Tube de raccordement, forme droite				
	Bestell-Nr. Order N° N° de commande		Gewinde thread pas de vis	
	1.0305 A 226 C 10 D	1.4571 316Ti Z6CNDT17-12	G1	G
	395409	395410	G1/2"	Ø20
	395411	395412	M20x1,5	
	Anschlusszapfen, DIN 16282 Form 6 Connection, DIN 16282 Form 6 Raccordement, DIN 16282 Form 6			
	396631	396633	G1/2"	G1/2"B-RH
	396632	396634	M20x1,5	G1/2"B-LH
	Anschlusszapfen, DIN 16282 Form 4 Connection, DIN 16282 Form 4 Raccordement, DIN 16282 Form 4			
	396635	396637	G1/2"	G1/2"B-RH
	396636	396638	M20x1,5	G1/2"B-LH
	Anschlusszapfen, mit Sechskant Connection with hex head Raccordement, avec tête hexagonale			
	396639	396641	G1/2"	G1/2B
	396640	396642	M20x1,5	

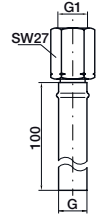
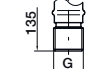
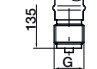
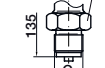
2- Wege - Verteiler Two- ways distributor Dérivation en té

Technische Daten	Technical Data	Caractéristiques techniques
Material Stahl, Edelstahl 1.4571, wahlweise Messing	Materials Steel, stainless steel 316Ti, alternatively brass	Matière Acier, acier inox Z6 CNDT 17-12, facultativement laiton
Zulässige Temperaturen T_{max} °C 120 °C bei 250 bar, Messing 150 °C bei 400 bar, Stahl 250 °C bei 400 bar, Edelstahl	Permissible temperatures T_{max} °C 120 °C at 250 bar, brass 150 °C at 400 bar, steel 250 °C at 400 bar, Stainless steel	Températures autorisées T_{max} °C 120 °C de 250 bar, laiton 150 °C de 400 bar, acier 250 °C de 400 bar, acier inox

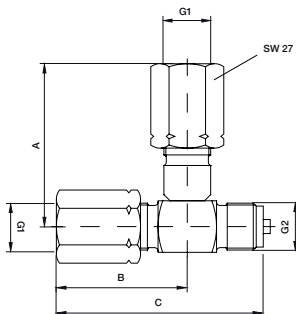

Bestell-Nr. Order N° N° de commande			Gewinde thread pas de vis		mm			kg
Messing brass laiton	Stahl steel Acier	1.4571 316Ti Z6CNDT17-12	G1	G2	A	B	C	
390664	390667	390670	G1/2	G 1/2 B	69,5	56	88,5	0,42
390663	390666	390669		M 20x1,5				
390665	390668	390671		1/2 NPT				

Stand: 24. 10. 2023