

Druckmessgerät mit Kapselfedersystem

Capsule pressure gauge

Manomètres capsule

K10

- **Anwendung**
Für nicht aggressive, gasförmige und trockene Messstoffe.
- **Service intended**
Suitable for all gaseous and liquid media that will not obstruct the pressure system.
- **Utilisation**
Pour fluides gazeux et liquides, non visqueux et non cristallisants.



Technische Daten	Technical Data	Caractéristiques techniques
Ausführung EN 837-3	Construction EN 837-3	Version EN 837-3
Gehäuse Ø 60, 100 und 160 mm, Edelstahl Schalttafeleinbaugeschäube DIN 43700 72x72, 96x96, 144x144, 144x72 und 192x96 mm Kunststoff, schwarz	Case Ø 60, 100 and 160 mm, stainless steel Panel mounting case DIN 43700 72x72, 96x96, 144x144, 144x72 and 192x96 mm Plastic, black	Boîtier Ø 60, 100 et 160 mm, acier inox Boîtier pour montage encastré DIN 43700 72x72, 96x96, 144x144, 144x72 et 192x96 mm Plastique, noir
Schutzart IP 54 nach EN 60529 / IEC 529	Degree of protection IP 54 per EN 60529 / IEC 529	Degré de protection IP 54 selon EN 60529 / IEC 529
Anschluss Ø 60, 72x72 mm : G1/4B, Messing Ø 100, 160 mm : G1/2B, Messing 144x144, 144x72 und 192x96mm : G1/2B, Messing	Pressure connection Ø 60, 72x72 mm : G1/4B, brass Ø 100, 160 mm : G1/2B, brass 144x144, 144x72 and 192x96mm : G1/2B, brass	Raccord pression Ø 60, 72x72 mm : G1/4B, laiton Ø 100, 160 mm : G1/2B, laiton 144x144, 144x72 et 192x96mm : G1/2B, laiton
Messorgan Kupferlegierung	Pressure element Copper alloy	Organe moteur Capsule en alliage de cuivre
Zeigerwerk Grund- und Deckplatte aus Messing Laufteile aus Neusilber	Movement Base and cover plate, brass Drive shaft, nickel silver	Mouvement Platines, laiton Axiale, argentan
Zeiger Aluminium, schwarz	Pointer Black, aluminium	Aiguille duralumin, noir
Zifferblatt Aluminium, weiß Skala und Beschriftung schwarz	Dial White, aluminium Black scale and lettering	Cadran Duralumin, blanc Echelle et graduation en noir
Sichtscheibe Ø 60 und Schalttafeleinbaugeschäube: Acrylglas Ø 100, 160 mm : Instrumentenglas	Window Ø 60 and panel mounting cases : acrylic glass Ø 100, 160 mm : instrument glass	Voyant Ø 60 et caisses de panneau : verre acrylique Ø 100, 160 mm : verre d'instrumentation
Nullpunkteinstellung Verstellschraube im Zifferblatt	Zero point adjustment Adjusting screw in dial	Correction du zéro Vis de réglage sur le cadran
Genauigkeitsklasse 1,6	Accuracy class 1,6	Précision 1,6
Temperatureinfluss, T_{Ref} 20°C Temperaturzunahme : +0,3% FS / 10K Temperaturabnahme : - 0,3% FS / 10K	Temperature error, T_{ref} 20°C Rising temperature: +0,3% of FS value / 10 K Falling temperature: -0,3% of FS value / 10 K	Influence de la température T_{ref} 20°C Hausse des températures: +0,3% de l'EM/10 K Baisse des températures : -0,3% de l'EM/10 K
Umgebungstemperatur T _{min} / T _{max} - 25 ... + 60°C	Ambient temperature T _{min} / T _{max} - 25 ... + 60°C	Température ambiante T _{mini} / T _{maxi} - 25 ... + 60°C
Messstofftemperatur T _{max} +100°C	Medium temperature T _{max} +100°C	Température du fluide T _{max} +100°C
Überlastbarkeit < 25 mbar : 6 x Skalenendwert > 25 mbar : 10 x Skalenendwert	Overpressure < 25 mbar : 6 x full scale value > 25 mbar : 10 x full scale value	Surpression < 25 mbar : 6 x de fin d'échelle > 25 mbar : 10 x de fin d'échelle
Ergänzungen siehe Tabelle Seite 03.0106	Optional extras see table page 03.0106	Options Voir tableau page 03.0106

Stand: 24. 10. 2023

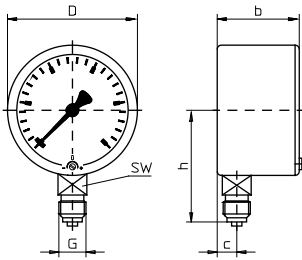

Typ K10.U.1.N60
Anschluss unten
bottom pressure entry
raccord en bas

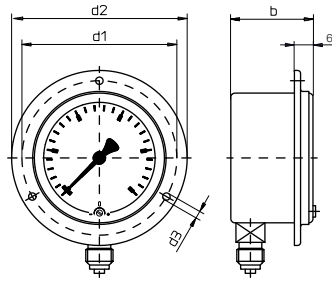

Typ K10.U.2.N60
Rand vorne
panel mounting flange
collerette avant

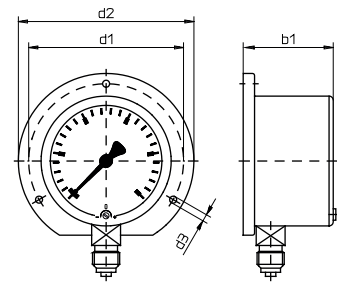

Typ K10.U.3.N60
Rand hinten
surface mounting flange
rebord arrière

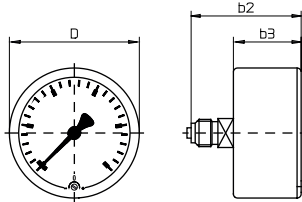

Typ K10.H.1.N60
Anschluss hinten
back pressure entry
raccord arrière

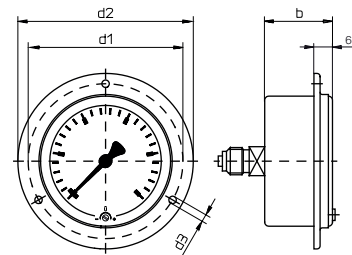

Typ K10.H.2.N60
Rand vorne
panel mounting flange
collerette avant

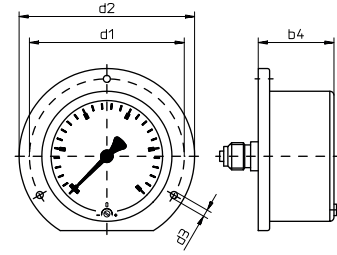

Typ K10.H.3.N60
Rand hinten
surface mounting flange
rebord arrière

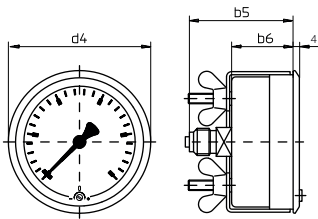

Typ K10.H.4.N60 *)
Dreikantfrontring
triangular bezel
collerette avant triangulaire

NG	b	b1	b2	b3	b4	b5	b6	c	D	d1	d2	d3	d4	G	h	SW	Tafelausschnitt panel cut-out découpe du panneau	1) kg		
	mm																65	*) 63	0,22	0,30
60	42	46	55	35	36	57	37	11	62	75	85	3,5	67	G¼B	54	14	65	*) 63	0,22	0,30

Druckmessgerät mit Kapselfedersystem

Capsule pressure gauge

Manomètres capsule

K10

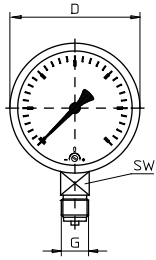

Typ K10.U.1.N...
Anschluss unten
bottom pressure entry
raccord en bas

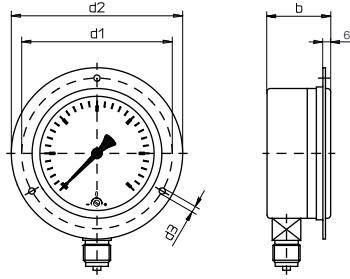

Typ K10.U.2.N...
Rand vorne
panel mounting flange
colerette avant

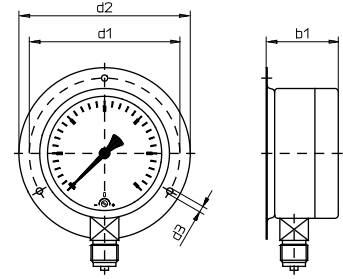

Typ K10.U.3.N...
Rand hinten
surface mounting flange
rebord arrière

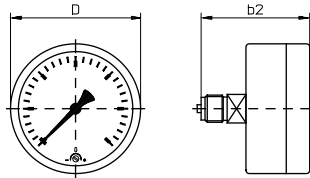

Typ K10.H.1.N...
Anschluss hinten
back pressure entry
raccord arrière

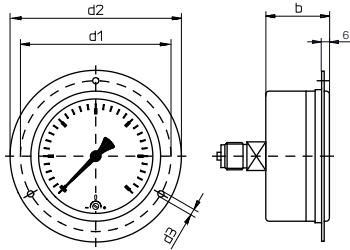

Typ K10.H.2.N...
Rand vorne
panel mounting flange
colerette avant

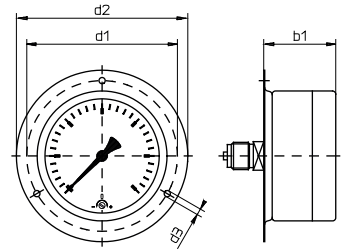

Typ K10.H.3.N...
Rand hinten
surface mounting flange
rebord arrière

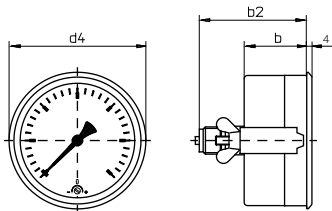

Typ K10.H.4.N... *)
Dreikantfrontring
triangular bezel
colerette avant triangulaire

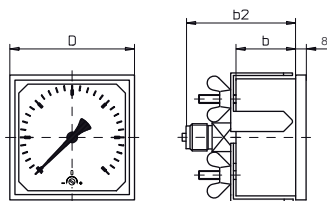

Typ K10.H.2.N...
Quadratgehäuse
square panel mounting
boîtier carré

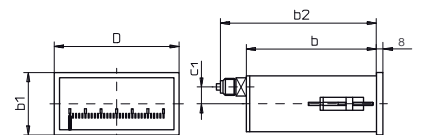

Typ K10.H.2.N...
Profilgehäuse
edgewise panel mounting
boîtier de profil

NG	b	b1	b2	c	c1	D	d1	d2	d3	d4	G	h	SW	Tafelausschnitt panel cut-out découpe du panneau		1)	
														mm		kg	
100	50	56	86,5	15	-	100	116	132	4,8	107	G $\frac{1}{2}$ B	87	22	105	*) 103	0,6	0,80
160	50	56	88	14,5	-	160	178	196	5,8	166				165	*) 163	1,1	1,95
72 x 72	38	-	58	-	-	72	-	-	-	-	G $\frac{1}{4}$ B	-		68 x 68	2,2	-	
96 x 96	47	-	81	-	-	96	-	-	-	-	-	-		92 x 92	0,8	-	
144 x 144	47	-	81	-	-	144	-	-	-	-	G $\frac{1}{2}$ B	-	138 x 138	1,1	-		
144 x 72	139,5	72	175	-	7	144	-	-	-	-		-	138 x 68	1,3	-		
192 x 96	139,5	96	175	-	7	192	-	-	-	-		-	186 x 92	2,4	-		



1) Gewicht mit Glycerinfüllung
Weight with glycerin filling
Poids avec remplissage de glycérine



K10

Druckmessgerät mit Kapselfedersystem

Capsule pressure gauge

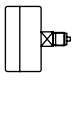
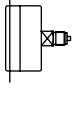
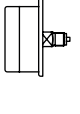
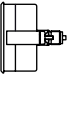
Manomètres capsule

Typ	K10.U.1.N60	K10.U.2.N60	K10.U.3.N60	K10.H.1.N60	K10.H.2.N60	K10.H.3.N60	K10.H.4.N60
Ø 60mm							
Anzeigebereich, mbar Scale range, mbar Etendues de mesure, mbar	Bestell-Nr. Order-N°. N° de commande						
- 25 ... 0 ... + 15	106228	106252	106276	106300	106325	106350	106372
- 20 ... 0 ... + 40	106229	106253	106277	106301	106326	106351	106373
- 40 ... 0 ... + 20	106230	106254	106278	106302	106327	106313	106374
- 25 ... 0	106234	106258	106282	106306	106331	106354	106378
- 40 ... 0	106235	106259	106283	106307	106332	106355	106379
- 60 ... 0	106236	106260	106284	106308	106333	106356	106380
- 100 ... 0	106237	106261	106285	106309	106334	106357	106381
- 160 ... 0	106238	106262	106286	106310	106335	106358	106382
- 250 ... 0	106239	106263	106287	106311	106336	106359	106383
- 400 ... 0	106240	106264	106288	106312	106337	106360	106384
0 ... 25	106244	106268	106292	106317	106342	106364	106388
0 ... 40	106245	106269	106293	106318	106343	106365	106389
0 ... 60	106246	106270	106294	106319	106344	106366	106390
0 ... 100	106247	106271	106295	106320	106345	106367	106391
0 ... 160	106248	106272	106296	106321	106346	106368	106392
0 ... 250	106249	106273	106297	106322	106347	106369	106393
0 ... 400	106250	106274	106298	106323	106348	106370	106394
0 ... 600	106251	106275	106299	106324	106349	106371	106395

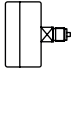
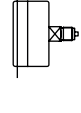
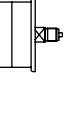
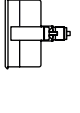
Typ	K10.U.1.N100	K10.U.2.N100	K10.U.3.N100	K10.H.1.N100	K10.H.2.N100	K10.H.3.N100	K10.H.4.N100
Ø 100mm							
Anzeigebereich, mbar Scale range, mbar Etendues de mesure, mbar	Bestell-Nr. Order-N°. N° de commande						
- 25 ... 0 ... + 15	106397	106422	106447	106472	106497	106522	106547
- 20 ... 0 ... + 40	106398	106423	106448	106473	106498	106523	106548
- 40 ... 0 ... + 20	106399	106424	106449	106474	106499	106524	106549
- 10 ... 0	106401	106426	106451	106476	106501	106526	106551
- 16 ... 0	106402	106427	106452	106477	106502	106527	106552
- 25 ... 0	106403	106428	106453	106478	106503	106528	106553
- 40 ... 0	106404	106429	106454	106479	106504	106529	106554
- 60 ... 0	106405	106430	106455	106480	106505	106530	106555
- 100 ... 0	106406	106431	106456	106481	106506	106531	106556
- 160 ... 0	106407	106432	106457	106482	106507	106532	106557
- 250 ... 0	106408	106433	106458	106483	106508	106533	106558
- 400 ... 0	106409	106434	106459	106484	106509	106534	106559
0 ... 10	106412	106437	106462	106487	106512	106537	106562
0 ... 16	106413	106438	106463	106488	106513	106538	106563
0 ... 25	106414	106439	106464	106489	106514	106539	106564
0 ... 40	106415	106440	106465	106490	106515	106540	106565
0 ... 60	106416	106441	106466	106491	106516	106541	106566
0 ... 100	106417	106442	106467	106492	106517	106542	106567
0 ... 160	106418	106443	106468	106493	106518	106543	106568
0 ... 250	106419	106444	106469	106494	106519	106544	106569
0 ... 400	106420	106445	106470	106495	106520	106545	106570
0 ... 600	106421	106446	106471	106496	106521	106546	106571

Stand: 24. 10. 2023

Druckmessgerät mit Kapselfedersystem

Capsule pressure gauge



Manomètres capsule

K10

Typ	K10.U.1.N160	K10.U.2.N160	K10.U.3.N160	K10.H.1.N160	K10.H.2.N160	K10.H.3.N160	K10.H.4.N160
Ø 160mm							
Anzeigebereich, mbar Scale range, mbar Etendues de mesure, mbar	Bestell-Nr. Order-N° N° de commande						
- 25 ... 0 ... + 15	106572	106597	106622	106647	106672	106697	106722
- 20 ... 0 ... + 40	106573	106598	106623	106648	106673	106698	106723
- 40 ... 0 ... + 20	106574	106599	106624	106649	106674	106699	106724
- 6 ... 0	106575	106600	106625	106650	106675	106700	106725
- 10 ... 0	106576	106601	106626	106651	106676	106701	106726
- 16 ... 0	106577	106602	106627	106652	106677	106702	106727
- 25 ... 0	106578	106603	106628	106653	106678	106703	106728
- 40 ... 0	106579	106604	106629	106654	106679	106704	106729
- 60 ... 0	106580	106605	106630	106655	106680	106705	106730
- 100 ... 0	106581	106606	106631	106656	106681	106706	106731
- 160 ... 0	106582	106607	106632	106657	106682	106707	106732
- 250 ... 0	106583	106608	106633	106658	106683	106708	106733
- 400 ... 0	106584	106609	106634	106659	106684	106709	106734
0 ... 6	106586	106611	106636	106661	106686	106711	106736
0 ... 10	106587	106612	106637	106662	106687	106712	106737
0 ... 16	106588	106613	106638	106663	106688	106713	106738
0 ... 25	106589	106614	106639	106664	106689	106714	106739
0 ... 40	106590	106615	106640	106665	106690	106715	106740
0 ... 60	106591	106616	106641	106666	106691	106716	106741
0 ... 100	106592	106617	106642	106667	106692	106717	106742
0 ... 160	106593	106618	106643	106668	106693	106718	106743
0 ... 250	106594	106619	106644	106669	106694	106719	106744
0 ... 400	106595	106620	106645	106670	106695	106720	106745
0 ... 600	106596	106621	106646	106671	106696	106721	106746

Typ	K10.H.2.72x72	K10.H.2.96x96	K10.H.2.144x144	K10.H.2.144x72	K10.H.2.192x96
72 x 72 96 x 96 144 x 144 mm 144 x 72 192 x 96					
Anzeigebereich, mbar Scale range, mbar Etendues de mesure, mbar	Bestell-Nr. Order-N° N° de commande				
- 25 ... 0 ... + 15	106747	106772	106797	106822	106847
- 20 ... 0 ... + 40	106748	106773	106798	106823	106848
- 40 ... 0 ... + 20	106749	106774	106799	106824	106849
- 6 ... 0	-	106775	106800	106825	106850
- 10 ... 0	-	106776	106801	106826	106851
- 16 ... 0	-	106777	106802	106827	106852
- 25 ... 0	106753	106778	106803	106828	106853
- 40 ... 0	106754	106779	106804	106829	106854
- 60 ... 0	106755	106780	106805	106830	106855
- 100 ... 0	106756	106781	106806	106831	106856
- 160 ... 0	106757	106782	106807	106832	106857
- 250 ... 0	106758	106783	106808	106833	106858
- 400 ... 0	106759	106784	106809	106834	106860
0 ... 6	-	106786	106811	106836	106862
0 ... 10	-	106787	106812	106837	106863
0 ... 16	-	106788	106813	106838	106864
0 ... 25	106764	106789	106814	106839	106865
0 ... 40	106765	106790	106815	106840	106866
0 ... 60	106766	106791	106816	106841	106867
0 ... 100	106767	106792	106817	106842	106868
0 ... 160	106768	106793	106818	106843	106869
0 ... 250	106769	106794	106819	106844	106870
0 ... 400	106770	106795	106820	106845	106871
0 ... 600	106771	106796	106821	106846	106872

Stand: 24. 10. 2023

Ergänzungsartikel Optional extras Options	Ø60	Ø100	Ø160	72 x 72 96 x 96 144 x 144	144 x 72 192 x 096
	Bestell-Nr. Order-N°. N° de commande				
Über-/ unterdrucksicher (< 25 mbar 3-fach, > 25 mbar 10-fach)	395506	395506	395506	395506	395506
Overpressure and vacuum safe (< 25 mbar 3-times, > 25 mbar 10-times)					
Résistant aux surpressions et au vide (< 25 mbar 3-fois, > 25 mbar 10-fois)					
Messsystem gereinigt für Sauerstoff	395501	395501	395501	395501	395501
Degreased pressure element for oxygen					
Organe moteur dégraissé pour oxygène					
Drosselschraube im Anschlusszapfen 0,8 mm Ø	395070	395070	395070	395070	395070
Restrictor screw in connector 0,8 mm dia.					
Vis frein de 0,8 mm dans le raccord					
Frontring schwarz lackiert	-	395004	395037	-	-
Bezel black painted					
Lunette peinte en noir					
rote Marke auf dem Zifferblatt	395074	395026	395026	395026	395026
Red mark on dial					
Trait rouge sur le cadran					
Gebrauchslage Querskala	-	-	-	-	395620
Horizontal scale reading					
Lecture de l'échelle horizontale					
Gebrauchslage Hochskala	-	-	-	-	395621
Vertical scale reading					
Lecture de l'échelle verticale					
Zündschutzart	104101	104101	104101	104101	104101
Intrinsic safety  II 2G Ex h IIC T6...T1 Gb X					
Sécurité intrinsèque  II 2D Ex h IIC T6...T1 Db X					